

WELDING ELBOW

Type: **1058...1** Body

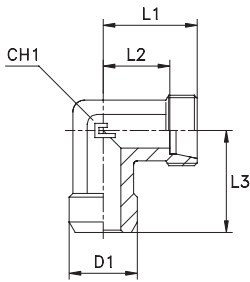

Type: **1058.. B3** Ring

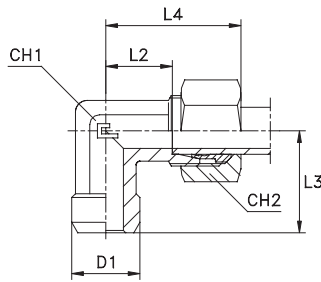

Type: **1058...4** B4 Ring

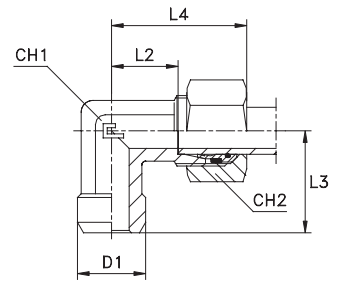

Series DIN	10.... [bar]	11.... [bar]	Ordering Body	Ordering Equipped B3	Ø Tube	D1	L1	L2	L3	L4	CH1	CH2	Ordering Equipped B4
L	315	315	105804.1	105804	6	10	19	12	19	27	12	14	105804.4
			105805.1	105805	8	12	21	14	21	29	12	17	105805.4
			105806.1	105806	10	14	22	15	22	30	14	19	105806.4
			105807.1	105807	12	16	24	17	24	32	17	22	105807.4
			105808.1	105808	15	19	28	21	28	36	19	27	105808.4
			105809.1	105809	18	22	31	23.5	31	40	24	32	105809.4
	160	160	105810.1	105810	22	27	35	27.5	35	44	27	36	105810.4
			105811.1	105811	28	32	38	30.5	38	47	36	41	105811.4
			105812.1	105812	35	40	45	34.5	45	56	41	50	105812.4
			105813.1	105813	42	46	51	40	51	63	50	60	105813.4
S	630	630	105814.1	105814	6	11	23	16	23	31	12	17	105814.4
			105815.1	105815	8	13	24	17	24	32	14	19	105815.4
			105816.1	105816	10	15	25	17.5	25	34	17	22	105816.4
			105817.1	105817	12	17	29	21.5	29	38	17	24	105817.4
			105818.1	105818	14	19	30	22	30	40	19	27	105818.4
			105819.1	105819	16	21	33	24.5	33	43	24	30	105819.4
	400	400	105820.1	105820	20	26	37	26.5	37	48	27	36	105820.4
			105821.1	105821	25	31	42	30	42	54	36	46	105821.4
			105822.1	105822	30	36	49	35.5	49	62	41	50	105822.4
			105823.1	105823	38	44	57	41	57	72	50	60	105823.4
	315	315											

Note: If you wish to order AISI 316 stainless steel fittings, please change the first two digits from **10....** to **11....** .
If you wish to order AISI 316 stainless steel fittings with AISI 304 stainless steel nuts, please change the first two digits from **10....** to **14....** .
Items not included in the ISO 8434-1 Norm available on request only.

GAUGE COUPLING

Thread BSP Parallel

Type: **1059...1** Body
Metal washer seal

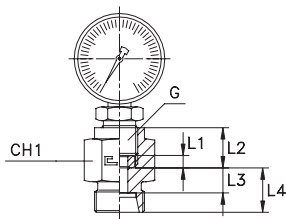

Type: **1059.. B3** Ring
Metal washer seal

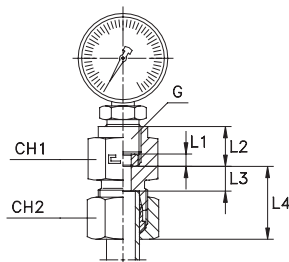

Type: **1059...4** B4 Ring
O-ring washer seal

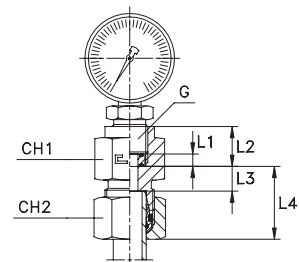

Series DIN	10.... [bar]	11.... [bar]	Ordering Body + Ferrule	Ordering Equipped B3	Ø Tube	G	L1	L2	L3	L4	CH1	CH2	Ordering Equipped B4
L	315	315	105904.1	105904	6	1/4	4.5	14.5	7.5	14.5	19	14	105904.4
			105905.1	105905	8	1/4	4.5	14.5	7.5	14.5	19	17	105905.4
			105906.1	105906	10	1/4	4.5	14.5	8.5	15.5	19	19	105906.4
			105907.1	105907	12	1/4	4.5	14.5	8.5	15.5	19	22	105907.4
S	630	630	105914.1	105914	6	1/2	5	20	11	18	30	17	105914.4
			105915.1	105915	8	1/2	5	20	11	18	30	19	105915.4
			105916.1	105916	10	1/2	5	20	10.5	18	30	22	105916.4
			105917.1	105917	12	1/2	5	20	10.5	18	30	24	105917.4

Note: If you wish to order AISI 316 stainless steel fittings, please change the first two digits from **10....** to **11....** .
If you wish to order AISI 316 stainless steel fittings with AISI 304 stainless steel nuts, please change the first two digits from **10....** to **14....** .
Items not included in the ISO 8434-1 Norm.
Gauge not included.