

MALE STUD COUPLING

Thread BSP Parallel

Type: **1003...1** Body

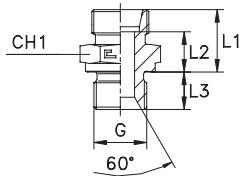

Type: **1003.. B3** Ring

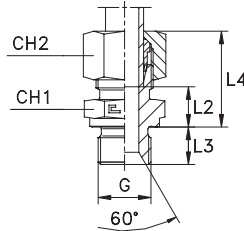

Type: **1003...4** B4 Ring

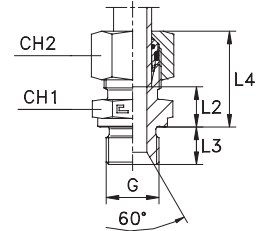

Series DIN	10.... [bar]	11.... [bar]	Ordering Body	Ordering Equipped B3	Ø Tube	G	L1	L2	L3	L4	CH1	CH2	Ordering Equipped B4
L	315	315	100304.1	100304	6	1/8	15,5	8,5	8	23	14	14	100304.4
			100305.1	100305	8	1/4	17	10	12	25	19	17	100305.4
			100306.1	100306	10	1/4	18	11	12	26	19	19	100306.4
			100307.1	100307	12	3/8	19,5	12,5	12	27	22	22	100307.4
			100308.1	100308	15	1/2	21	14	14	29	27	27	100308.4
	100309.1	100309	18	1/2	22	14,5	14	31	27	32	100309.4		
	160	160	100310.1	100310	22	3/4	24	16,5	16	33	32	36	100310.4
			100311.1	100311	28	1	25	17,5	18	34	41	41	100311.4
			100312.1	100312	35	1 1/4	28	17,5	20	39	50	50	100312.4
			100313.1	100313	42	1 1/2	30	19	22	42	55	60	100313.4
100314.1			100314	6	1/4	20	13	12	28	19	17	100314.4	
S	630	630	100315.1	100315	8	1/4	22	15	12	30	19	19	100315.4
			100316.1	100316	10	3/8	22,5	15	12	31	22	22	100316.4
			100317.1	100317	12	3/8	24,5	17	12	33	22	24	100317.4
			100318.1	100318	14	1/2	27	19	14	37	27	27	100318.4
			100319.1	100319	16	1/2	27	18,5	14	37	27	30	100319.4
	400	400	100320.1	100320	20	3/4	31	20,5	16	42	32	36	100320.4
			100321.1	100321	25	1	35	23	18	47	41	46	100321.4
			100322.1	100322	30	1 1/4	37	23,5	20	50	50	50	100322.4
			100323.1	100323	38	1 1/2	42	26	22	57	55	60	100323.4
			L	315	315	100324.1*	100324*	6	1/4	17	10	12	24,5
100325.1*	100325*	8				1/8	16,5	9,5	8	24,5	14	17	100325.4*
100326.1*	100326*	8				3/8	18,5	11,5	12	26,5	22	17	100326.4*
100327.1*	100327*	8				1/2	19	12	14	27	27	17	100327.4*
100328.1*	100328*	10				1/8	17,5	10,5	8	25,5	17	19	100328.4*
100329.1*	100329*	10				3/8	19,5	12,5	12	27,5	22	19	100329.4*
100330.1*	100330*	10				1/2	20	13	14	28	27	19	100330.4*
100331.1*	100331*	12				1/4	19	12	12	26,5	19	22	100331.4*
100332.1*	100332*	12				1/2	20	13	14	27,5	27	22	100332.4*
100333.1*	100333*	15				3/8	20,5	13,5	12	28,5	24	27	100333.4*
100334.1*	100334*	18	3/4	22	14,5	16	31	32	32	100334.4*			
S	630	630	100335.1*	100335*	12	1/2	25	17,5	14	33,5	27	24	100335.4*
			100336.1*	100336*	14	3/8	26,5	18,5	12	36,5	24	27	100336.4*
	400	400	100337.1*	100337*	16	3/8	26,5	18	12	36,5	27	30	100337.4*
			100338.1*	100338*	20	1/2	31	20,5	14	42	32	36	100338.4*
			100339.1*	100339*	25	3/4	35	23	16	47	41	46	100339.4*
			100340.1*	100340*	30	1	37	23,5	18	50	46	50	100340.4*
	630	630	100341.1*	100341*	8	3/8	22,5	15,5	12	30,5	22	19	100341.4*
			100342.1*	100342*	10	1/4	22	14,5	12	30,5	19	22	100342.4*
			100343.1*	100343*	10	1/2	25	17,5	14	33,5	27	22	100343.4*
			100344.1*	100344*	12	1/4	24	16,5	12	32,5	22	24	100344.4*
400	400	100345.1*	100345*	16	3/4	29	20,5	16	39	32	30	100345.4*	
		100346.1*	100346*	20	1	33	22,5	18	44	41	36	100346.4*	
315	315	100347.1*	100347*	38	1 1/4	42	26	20	57	55	60	100347.4*	
L	315	315	100348.1*	100348*	15	3/4	22	15	16	30	32	27	100348.4*
			100349.1*	100349*	22	1/2	24	16,5	14	33	32	36	100349.4*
	160	160	100350.1*	100350*	22	1	25	17,5	18	34	41	36	100350.4*
			100351.1*	100351*	28	3/4	25	17,5	16	34	41	41	100351.4*
			100352.1*	100352*	35	1	28	17,5	18	39	46	50	100352.4*
			100353.1*	100353*	6	3/8	18,5	11,5	12	26	22	14	100353.4*
	160	160	100354.1*	100354*	42	1 1/4	30	19	20	42	55	60	100354.4*

Note: If you wish to order AISI 316 stainless steel fittings, please change the first two digits from **10....** to **11....** .
 If you wish to order AISI 316 stainless steel fittings with AISI 304 stainless steel nuts, please change the first two digits from **10....** to **14....** .
 * Items available on request only.