

SAE WHOLE 90° FLANGE 6000 PSI SERIES - SAE J518

Code: **8054..**
Type: **SFS90**

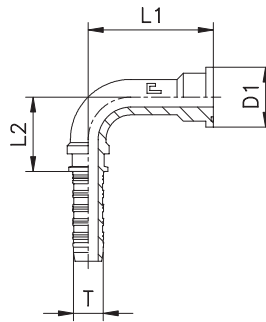

CODE	I.D. hose T			Ø flange	D1	L1	L2	PN [bar]
	DN	size	INCH					
805401	12	-8	1/2	1/2	31,8	42	36	415
805402	12	-8	1/2	3/4	41,3	50	36	415
805403	16	-10	5/8	3/4	41,3	52	40	350
805404	19	-12	3/4	3/4	41,3	56	53,5	350
805405	19	-12	3/4	1	47,6	62	53,5	350
805406	25	-16	1	1	47,6	68	64,5	280
805407	25	-16	1	1 1/4	54	75	64,5	280
805408	31	-20	1 1/4	1 1/4	54	86	75,5	210
805409	31	-20	1 1/4	1 1/2	63,5	94,5	75,5	210
805410	38	-24	1 1/2	1 1/2	63,5	105	101	185
805411	38	-24	1 1/2	2	79,4	121	104	185
805412	51	-32	2	2	79,4	136,5	137,5	165

Notes: If you wish to order a fitting in stainless steel, please change the first two digit from **80....** to **81....** .

SAE WHOLE 45° FLANGE 6000 PSI SERIES - SAE J518

Code: **8055..**
Type: **SFL90**

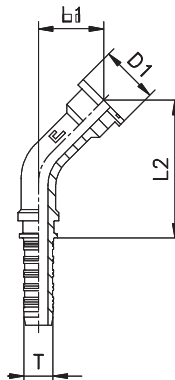

CODE	I.D. hose T			Ø flange	D1	L1	L2	PN [bar]
	DN	size	INCH					
805501	12	-8	1/2	1/2	31,8	21,5	62,5	415
805502	12	-8	1/2	3/4	41,3	27	68	415
805503	16	-10	5/8	3/4	41,3	27	73	350
805504	19	-12	3/4	3/4	41,3	28,5	87,5	350
805505	19	-12	3/4	1	47,6	32,5	91,5	350
805506	25	-16	1	1	47,6	33	106	280
805507	25	-16	1	1 1/4	54	38	111	280
805508	31	-20	1 1/4	1 1/4	54	41	128	210
805509	31	-20	1 1/4	1 1/2	63,5	47	134	210
805510	38	-24	1 1/2	1 1/2	63,5	50,5	165	185
805511	38	-24	1 1/2	2	79,4	61,5	176,5	185
805512	51	-32	2	2	79,4	64	219,5	165

Notes: If you wish to order a fitting in stainless steel, please change the first two digit from **80....** to **81....** .