

# ADJUSTABLE MALE STUD BRANCH TEE WITH O-RING

Thread UNF/UN-2A

Type: 4062..

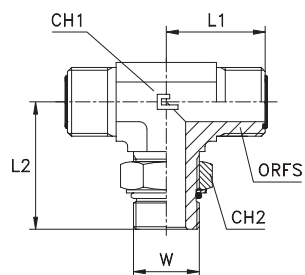

Series ORFS	40.... [bar]	41.... [bar]	Ordering Complete	Ø Tube M	Ø Tube W	W	L1	L2	CH1	CH2	ORFS		
UNIVERSAL	420	420	406201	6	1/4	7/16-20	21,5	32,5	14	14	9/16-18		
			406202	8-10	5/16-3/8	9/16-18	25	37	19	17	11/16-16		
			406203	12	1/2	3/4-16	28	40,5	19	22	13/16-16		
			406204	14-15-16	5/8	7/8-14	33,5	50	27	27	1-14		
			406205	18-20	3/4	1 1/16-12	37,5	55	30	32	13/16-12		
	380	380	406206	22-25	7/8-1	15/16-12	41,5	59,5	36	41	17/16-12		
	280	280	406207	28-30-32	1 1/4	15/8-12	44,5	62	41	50	111/16-12		
			406208	35-38	1 1/2	17/8-12	49	66	48	55	2-12		
	420	420	406209	6	1/4	9/16-18	21,5	34,5	14	17	9/16-18		
			406210	6	1/4	3/4-16	23,5	40,5	19	22	9/16-18		
			406211	8-10	5/16-3/8	7/16-20	25	35	19	14	11/16-16		
			406212	8-10	5/16-3/8	3/4-16	25	40,5	19	22	11/16-16		
			406213	8-10	5/16-3/8	7/8-14	28	50	22	27	11/16-16		
			406214	8-10	5/16-3/8	1 1/16-12	29,5	55	27	32	11/16-16		
			406215	12	1/2	9/16-18	28	37	19	17	13/16-16		
			406216	12	1/2	7/8-14	30	50	22	27	13/16-16		
			406217	12	1/2	1 1/16-12	31,5	55	27	32	13/16-16		
			406218	14-15-16	5/8	3/4-16	33,5	46	27	22	1-14		
			406219	14-15-16	5/8	1 1/16-12	33,5	55	27	32	1-14		
			406220	18-20	3/4	3/4-16	37,5	47	30	22	13/16-12		
			406221	18-20	3/4	7/8-14	37,5	51	30	27	13/16-12		
			380	380	406222	18-20	3/4	15/16-12	38	59,5	33	41	13/16-12
			420	420	406223	22-25	7/8-1	1 1/16-12	41,5	59	36	32	17/16-12
	406224	22-25			7/8-1	15/8-12	44,5	62	41	50	17/16-12		
	280	280	406225	28-30-32	1 1/4	15/16-12	44,5	62	41	41	111/16-12		
			406226	28-30-32	1 1/4	17/8-12	48,5	66	48	55	111/16-12		
			406227	35-38	1 1/4	15/8-12	49	66	48	50	2-12		

Notes: If you wish to order a fitting in stainless steel, please change the first two digit from 40.... to 41....