

## EQUAL ELBOW

Type: 4043..

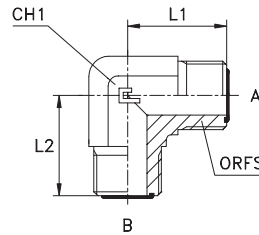

Series ORFS	40.... [bar]	41.... [bar]	Ordering Complete	Ø Tube A <sup>M</sup>	Ø Tube B <sup>M</sup>	Ø Tube A <sup>W</sup>	Ø Tube B <sup>W</sup>	L1	L2	CH1	ORFS A	ORFS B
UNIVERSAL	630	630	404301	6	6	1/4	1/4	21,5	21,5	14	9/16-18	9/16-18
			404302	8-10	8-10	5/16-3/8	5/16-3/8	25	25	19	11/16-16	11/16-16
			404303	12	12	1/2	1/2	28	28	19	13/16-16	13/16-16
	420	420	404304	14-15-16	14-15-16	5/8	5/8	33,5	33,5	27	1-14	1-14
			404305	18-20	18-20	3/4	3/4	37,5	37,5	30	1 <sub>3</sub> /16-12	1 <sub>3</sub> /16-12
			404306	22-25	22-25	7/8-1	7/8-1	41,5	41,5	36	1 <sub>7</sub> /16-12	1 <sub>7</sub> /16-12
	280	280	404307	28-30-32	28-30-32	1 <sup>1</sup> / <sub>4</sub>	1 <sup>1</sup> / <sub>4</sub>	44,5	44,5	41	1 <sub>11</sub> /16-12	1 <sub>11</sub> /16-12
			404308	35-38	35-38	1 <sup>1</sup> / <sub>2</sub>	1 <sup>1</sup> / <sub>2</sub>	49	49	48	2-12	2-12
	630	630	404309	8-10	6	5/16-3/8	1/4	25	23,5	19	11/16-16	9/16-18
			404310	12	8-10	1/2	3/8-5/16	28	25	19	13/16-16	11/16-16
	420	420	404311	14-15-16	12	5/8	1/2	33,5	31,5	27	1-14	13/16-16
			404312	18-20	8-10	3/4	5/16-3/8	37,5	32,5	30	1 <sub>3</sub> /16-12	11/16-16
			404313	18-20	12	3/4	1/2	37,5	34,5	30	1 <sub>3</sub> /16-12	13/16-16
			404314	18-20	14-15-16	3/4	5/8	37,5	36,5	30	1 <sub>3</sub> /16-12	1-14
			404315	22-25	18-20	7/8-1	3/4	41,5	41	36	1 <sub>7</sub> /16-12	13/16-12
	280	280	404316	28-30-32	22-25	1 <sup>1</sup> / <sub>4</sub>	7/8-1	44,5	44,5	41	1 <sub>11</sub> /16-12	1 <sub>7</sub> /16-12

Notes: If you wish to order a fitting in stainless steel, please change the first two digit from 40.... to 41.... .

## EQUAL 45° ELBOW

Type: 4044..

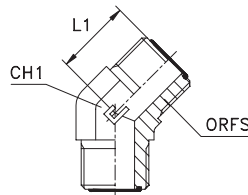

Series ORFS	40.... [bar]	41.... [bar]	Ordering Complete	Ø Tube M	Ø Tube W	L1	CH1	ORFS
UNIVERSAL	630	630	404401	6	1/4	16	14	9/16-18
			404402	8-10	5/16-3/8	19	19	11/16-16
			404403	12	1/2	20,5	19	13/16-16
	420	420	404404	14-15-16	5/8	23,5	27	1-14
			404405	18-20	3/4	26	30	1 <sub>3</sub> /16-12
			404406	22-25	7/8-1	30	36	1 <sub>7</sub> /16-12
	280	280	404407	28-30-32	1 <sup>1</sup> / <sub>4</sub>	32	41	1 <sub>11</sub> /16-12
			404408	35-38	1 <sup>1</sup> / <sub>2</sub>	37	48	2-12

Notes: If you wish to order a fitting in stainless steel, please change the first two digit from 40.... to 41.... .